

## IronGrip KK-100 Thimble Clamp

### Technical Specifications

Name	Lin Ø	D	d	A	G	L	Vikt (kg/100)
KK-600	5-6	36	16	12	26	74	16
KK-900	7-9,5	54	24	18	40	104	48
KK-1200	10-12,5	74	30	25	58	144	102
KK-1600	13-16,5	95	40	28	72	190	197
KK-M20*	17-20	166	68	37	80	244	370

\*Denna storlek finns endast i modell KK-M

#### Antal extra linlås

Name	Static load	Lifting 1770 N/mm <sup>2</sup> wire	Lifting 1960 N/mm <sup>2</sup> wire
KK-600	0	0	0
KK-900	0	0	0
KK-1200	0	0	1
KK-1600	0	0	1
KK-M20*	0	1	1

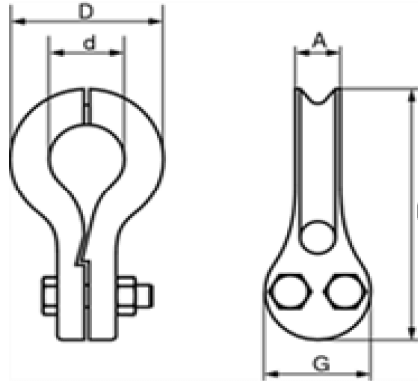

#### Material Specification:

Cast steel GS-60

Strength class for bolts, KK-1600: 10.9 in accordance with ISO 3506

Strength class for bolts, all other sizes: 8.8 in accordance with ISO 3506

Rustproofing of castings: Hot dip galvanisation in accordance with ISO 1461

Rustproofing of bolts: Electrically galvanised in accordance with ISO 2081

Recommended for all kinds of lifting applications according to the above, for wire ropes of tenacity class including 1960 N/mm<sup>2</sup>

Tested and approved according to EN 13411-3:2004